



Reference 8200

2 Bed Apartment with roof garden in Pyla, Larnaca

**€283,088** +VAT

Pyla, Larnaca

2 Bedrooms

2 Bathrooms

79.8 m<sup>2</sup> Covered

## Description

- 2 bedrooms
- 2 W/C
- Internal Area 79.80m<sup>2</sup>
- Covered Verandas 12.50m<sup>2</sup>
- Roof Garden 29.20m<sup>2</sup>
- Covered Parking
- Communal Swimming Pool
- Gym
- Playground
- Four-minute drive to the beach

Covered veranda 12.5 m<sup>2</sup>

Roof garden 29.2 m<sup>2</sup>

Parking spaces 1

Energy efficiency rating A

Status Under construction



## Facilities

- ✓ Parking · Covered
- ✓ Childrens playground
- ✓ Pool · Communal
- ✓ Gym

## Features

- ✓ Veranda
- ✓ Modern design
- ✓ Near amenities
- ✓ Open plan
- ✓ Entrance gate
- ✓ Luxury specifications
- ✓ Panoramic view
- ✓ Roof Garden
- ✓ Investment opportunity

## Gallery

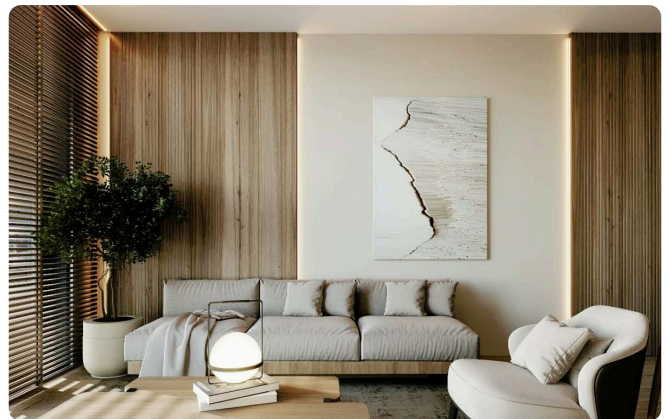



# Floor plans

## 1 BED ROOM

1 1 66 sqm

TYPE 1



TYPE 2

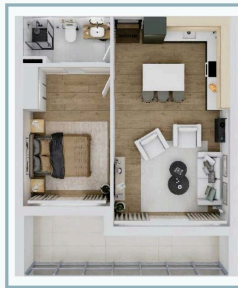

## 2 BED ROOM

2 2 98 sqm

TYPE 1



TYPE 2



# 3 BED ROOM

3 3 129 sqm

TYPE 1



TYPE 2

