



Reference 19192

1 Bed Penthouse Apartment in Germasogeia, Limassol

€250,000 +VAT

Germasogia, Limassol

1 Bedroom

1 Bathroom

49.75 m² Covered

Description

- 1 bedroom
- 1 W/C
- Internal Area 49.75m²
- Covered Verandas 12.95m²
- Covered Parking
- Communal Swimming Pool
- Storage
- Energy Efficiency "A"

Covered veranda	12.95 m ²
Parking spaces	1
Energy efficiency rating	A
Year of construction	2027
Status	Under construction



Facilities

✓ Parking · Covered ✓ Pool · Communal ✓ Elevator ✓ Storage

Features

✓ Veranda ✓ Modern design ✓ Near amenities ✓ Open plan ✓ Easy access to highway
✓ Thermal insulation

Gallery



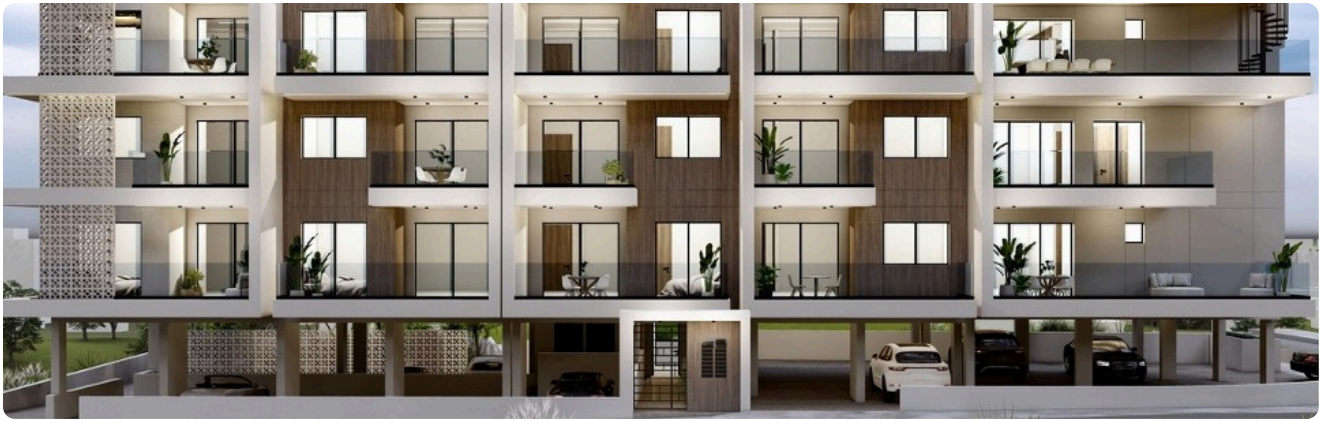

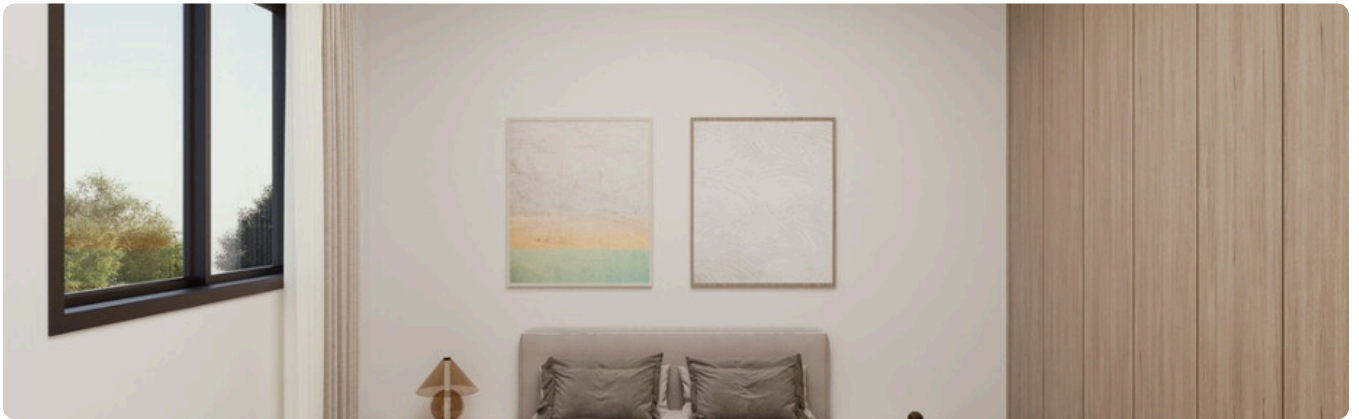

Floor plans

