



Reference 1473

1 Bed Apartment In Strovolo, In Walking Distance From European University **€135,000**

Strovolos - Chryseleousa, Strovolos, Nicosia

1 Bedroom | 1 Bathroom | 51 m² Covered

Description

SOLD

1 Bed Apartment In Strovolo, In Walking Distance From European University

- ◆ 1 bedrooms
- ◆ 1 W/C
- ◆ Internal Area 51m²
- ◆ Covered Verandas 13m²
- ◆ Modern Architecture
- ◆ Energy Efficiency "A"

Covered veranda **13 m²**

Energy efficiency rating **A**



Facilities

- ✓ Aircondition · Provision
- ✓ Storage
- ✓ Heating · Provision
- ✓ Solar water heater

Features

- ✓ Pressurized water system
- ✓ Thermal insulation
- ✓ Shutters, electric

Gallery



BLOCK A					
	AP.	COVER AREA M2	COVER M2	BED	PARKING
1 ST FLOOR	A 101	51.50 m ²	12.65 m ²	1	11.50 m ²
	A 102	51.50 m ²	12.65 m ²	1	11.50 m ²
	A 103	52.45 m ²	12.55 m ²	1	11.50 m ²
	A 104	51.40 m ²	13.60 m ²	1	11.50 m ²
	A 105	52.45 m ²	12.55 m ²	1	11.50 m ²
2 ND FLOOR	A 201	51.50 m ²	12.65 m ²	1	11.50 m ²
	A 202	51.50 m ²	12.65 m ²	1	11.50 m ²
	A 203	52.45 m ²	12.55 m ²	1	11.50 m ²
	A 204	51.40 m ²	13.60 m ²	1	11.50 m ²
	A 205	52.45 m ²	12.55 m ²	1	11.50 m ²
3 RD FLOOR	A 301	51.50 m ²	12.65 m ²	1	11.50 m ²
	A 302	51.50 m ²	12.65 m ²	1	11.50 m ²
	A 303	52.45 m ²	12.55 m ²	1	11.50 m ²
	A 304	51.40 m ²	13.60 m ²	1	11.50 m ²
	A 305	52.45 m ²	12.55 m ²	1	11.50 m ²
4 TH FLOOR	A 401	51.50 m ²	12.65 m ²	1	11.50 m ²
	A 402	51.50 m ²	12.65 m ²	1	11.50 m ²
	A 403	52.45 m ²	12.55 m ²	1	11.50 m ²
	A 404	51.40 m ²	13.60 m ²	1	11.50 m ²
	A 405	52.45 m ²	12.55 m ²	1	11.50 m ²
5 TH FLOOR	A 501	51.50 m ²	12.65 m ²	1	11.50 m ²
	A 502	51.50 m ²	12.65 m ²	1	11.50 m ²
	A 503	52.45 m ²	12.55 m ²	1	11.50 m ²
	A 504	51.40 m ²	13.60 m ²	1	11.50 m ²
	A 505	52.45 m ²	12.55 m ²	1	11.50 m ²



Floor plans

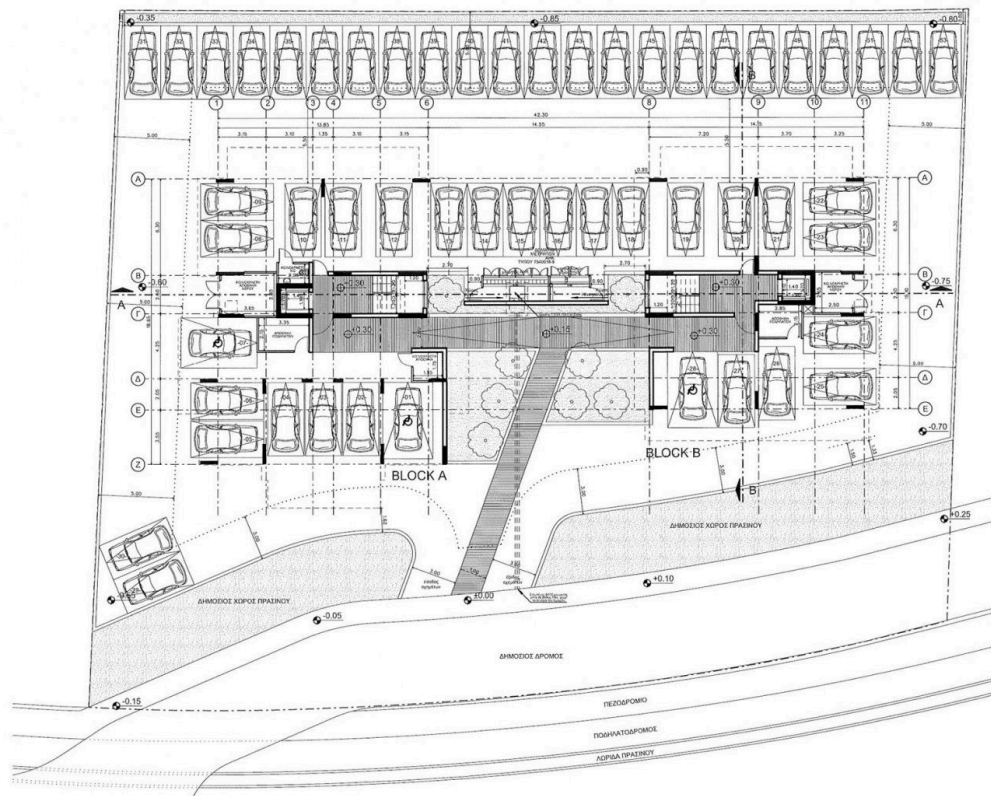

ΤΥΠΙΚΗ ΚΑΤΟΙΚΙΑ ΟΡΟΦΟΥ (2^η = 3^η, 4^η = 5^η ορόφου)

