



Reference 10552

2 Bed Penthouse Apartment in Potamos Germasogias, Limassol

€940,000 +VAT

Potamos Germasogeias, Limassol

2 Bedrooms | 2 Bathrooms | 110 m² Covered

Description

- 2 Bedroom
- 2 W/C
- Internal Area 110m²
- Covered Verandas 35m²
- Uncovered Area 14m²
- En Suite Bathroom
- Guest
- Covered Parking
- Storage
- Common Pool
- Garden
- Energy Efficiency "A"

| | |
|--------------------------|--------------------|
| Covered veranda | 35 m ² |
| Uncovered veranda | 14 m ² |
| Parking spaces | 1 |
| Energy efficiency rating | A |
| Year of construction | 2026 |
| Status | Under construction |



Facilities

- ✓ Aircondition · Split system ✓ Parking · Covered ✓ Pool · Communal ✓ Elevator ✓ Storage
- ✓ Solar water heater ✓ Solar photovoltaic panels (provision)
-

Features

- ✓ Guest WC ✓ Veranda ✓ Ceramic tiles ✓ CCTV ✓ En suite bathroom
- ✓ Luxury specifications ✓ Modern design ✓ Double glazing ✓ Open plan
- ✓ Easy access to main roads ✓ Sound insulation ✓ Thermal insulation
-

Gallery

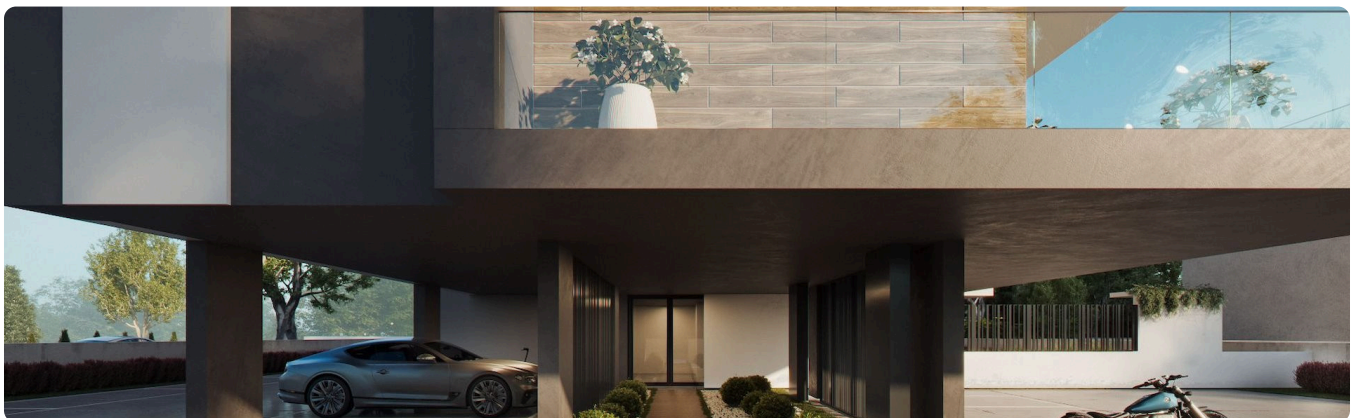
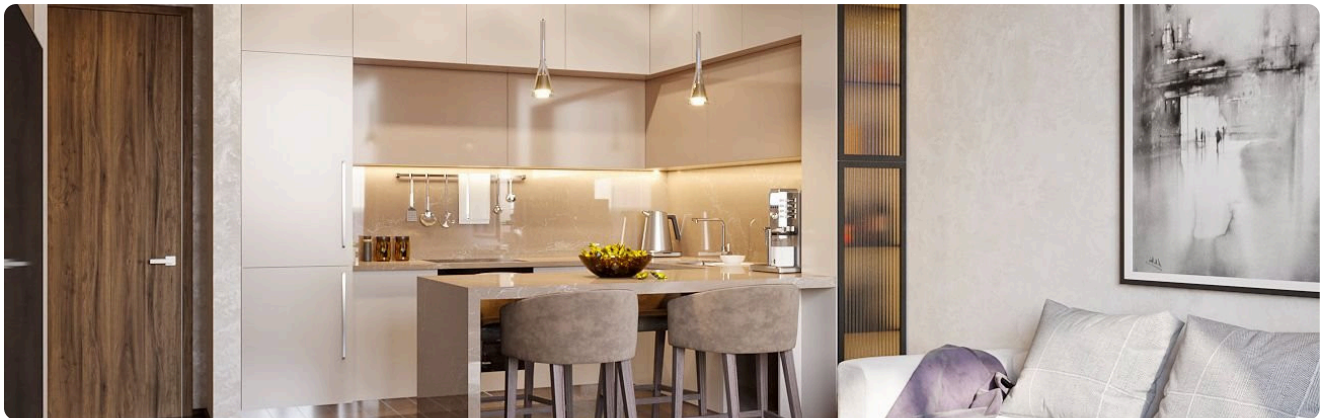







Floor plans

